

Genting I Tour Package

云顶 I 旅游配套

First

World Hotel

FLASH

SALE

Business Account



WhatsApp +65 8710 7707



www.707-inc.com

Favored ★★★★★ Sold 57388



行程仅供参考, 最终行程可能会根据实际情况进行微调。须符合条规

The itinerary is for reference only, the final itinerary may be fine-tuned according to the actual situation. Terms Apply*



Resorts World
GENTING

FLASH

SALE



**Optional Theme Park
Tickets Available**

附加主题公园门票

\$39 PWP \$45 Ticket Only

SkyWorlds Theme Park: Theme Park Ride

<https://www.gentingskyworlds.com/>

- * SkyWorlds Outdoor Theme Park.
- * Redemption At 707- Inc Counter.
- * Closed Every Tuesday.
- * Except Malaysia Public Holidays.
- * No Amendment, Cancellation or Revalidate.
- * Ticket Sold NO REFUND.

Auspicious Package

Dynamic Pricing Subject To Change, Limited Allotment

价格有变动的可能, 售完为止

Business Account

WhatsApp +65 8710 7707

www.707-inc.com

Favored ★★★★★ Sold 57388

行程仅供参考, 最终行程可能会根据实际情况进行微调。须符合条规

The itinerary is for reference only, the final itinerary may be fine-tuned according to the actual situation. Terms Apply*



Simple Step To Quote 报价步骤

Step 1 : Select A Hotels 选择您的酒店

- # **Resorts World Awana** 阿娃娜酒店
- # **First World Hotel** 云顶第一大酒店
- # **Genting SkyWorlds Hotel** 云顶天城世界
- # **Crockfords Hotel** 康乐福酒店
- # **Genting Grand** 云顶大酒店
- # **Resort Hotel** 名胜酒店

Step 2 : Select Your Check In Date 选择您的入住日期

Base On Colour Season, Per Room Per Night.

以颜色区分季节，每房每晚为准。

Step 3 : Select Number Of Traveler 选择旅客人数

(Child Below 2 Years Old No Seat Required 2岁以下儿童无需座位)

Base On Colour Season, Per Pax.

以颜色区分季节，每人为准。

Step 4 : To Book Provide Detail 预订提供以下资料

Number Of Travellers	出发人数
Hotel Name	酒店名
Check In Date	入住日期
Check Out Date	退房日期
Number Of Hotel Room	酒店房间数量
Bus Timing AM / PM	巴士发车时间 上午 / 下午

Optional Theme Park Tickets Available 附加主题公园门票 \$39 PWP \$45 Ticket Only

Remark 备注

- # **Dynamic Pricing Subject To Change, Limited Allotment** 价格有变动的可能，售完为止
- # **Exclude Tourism & Sustainability Tax, Security Deposit & Travel Insurance**
不含旅游税&可持续发展税，押金和旅游保险
- # **Booking Is Subjected To Availability & Confirmation** 一切预订以最终确认书为准
- # **Terms & Condition Apply** 需符合条规

Example: Quote:

Additional Theme Park Ticket \$39 PWP / \$45 Per Pax

Example 1 : Genting Package: First World Y5 Deluxe

Coach A: + Hotel B: 3 Days 2 Nights - (4 Pax + 3 Room) - Departure: 11 To 13/01/24

70

A Coach Transfer: 4 Pax X \$70 = \$280 (Base On Highest At Season)

112 + 152 B Hotel: First World Hotel - Type: Y5 Deluxe x 02 Room X \$264 = \$528

Coach A: + Hotel B: Grand Total: \$280 + \$528 = \$808 /4 Average \$202 Per Pax

Example 2 : Genting Package: First World Y5 Triple

Coach A: + Hotel B: 2 Days 1 Nights - (3 Pax + 1 Room) - Departure: 13 To 14/01/24

70 A Coach Transfer: 3 Pax X \$70 = \$210 (Base On Highest At Season)

162 B Hotel: First World Hotel - Type: Y5 Triple x 01 Room X \$162 = \$162

Coach A: + Hotel B: Grand Total: \$210 + \$162 = \$372 /3 Average \$124 Per Pax

Example 3 : Genting Package: SkyWorld Quad

Coach A: + Hotel B: 4 Days 3 Nights - (5 Pax + 1 Room) - Departure: 13 To 16/06/24

120

A Coach Transfer: 5 Pax X \$120 = \$600 (Base On Highest At Season)

210 + 250 + 260 B Hotel: SkyWorld Hotel - Type: Quad x 01 Room X \$720 = \$720

Coach A: + Hotel B: Grand Total: \$600 + \$720 = \$1320 /5 Average \$264 Per Pax

Example 4 : Genting Package: SkyWorld Sixers

Coach A: + Hotel B: 3 Days 2 Nights - (15 Pax + 2 Room) - Departure: 07 To 09/01/24

63

A Coach Transfer: 15 Pax X \$63 = \$945 (Base On Highest At Season)

222 + 222 B Hotel: SkyWorld Hotel - Type: Sixers x 02 Room X \$444 = \$888

Coach A: + Hotel B: Grand Total: \$945 + \$888 = \$1833 /15 Average \$122 Per Pax

Optional Theme Park Tickets Available 附加主题公园门票 \$39 PWP \$45 Ticket Only

行程仅供参考, 最终行程可能会根据实际情况进行微调。须符合条规

The itinerary is for reference only, the final itinerary may be fine-tuned according to the actual situation. Terms Apply*

First World Hotel

第一大酒店

Y5 Deluxe Room



Y5 Triple Room



Superior Deluxe Room



Worldclub Room



I Tour Package Include 配套包括:

Optional Theme Park Tickets Available 附加主题公园门票\$39
PWP \$45 Ticket Only

Two Way Coach : Singapore Genting Singapore

来回车程: 新加坡 - 云顶 - 新加坡

Stay At Hotel (Twin)

入住酒店 (两人一房)



SkyWay Return Transfer Once Only (02 Pax)

一趟来回缆车服务 (两人)

Daily Buffet Breakfast at Food Factory (02 Pax)

每日自助早餐于美食工坊 (两人)



Optional Theme Park Tickets

行程仅供参考, 最终行程可能会根据实际情况进行微调。须符合条规

The itinerary is for reference only, the final itinerary may be fine-tuned according to the actual situation. Terms Apply*

Genting First World Hotel

云顶第一大酒店

January (一月) 25							February (二月) 25							March (三月) 24							April (四月) 24						
Sun	Mon	Tue	Wed	Thu	Fri	Sat	Sun	Mon	Tue	Wed	Thu	Fri	Sat	Sun	Mon	Tue	Wed	Thu	Fri	Sat	Sun	Mon	Tue	Wed	Thu	Fri	Sat
			1	2	3	4							1	31					1	2		1	2	3	4	5	6
5	6	7	8	9	10	11	2	3	4	5	6	7	8	3	4	5	6	7	8	9	7	8	9	10	11	12	13
12	13	14	15	16	17	18	9	10	11	12	13	14	15	10	11	12	13	14	15	16	14	15	16	17	18	19	20
19	20	21	22	23	24	25	16	17	18	19	20	21	22	17	18	19	20	21	22	23	21	22	23	24	25	26	27
26	27	28	29	30	31		23	24	25	26	27	28		24	25	26	27	28	29	30	28	29	30				
May (五月) 24							June (六月) 24							July (七月) 24							August (八月) 24						
Sun	Mon	Tue	Wed	Thu	Fri	Sat	Sun	Mon	Tue	Wed	Thu	Fri	Sat	Sun	Mon	Tue	Wed	Thu	Fri	Sat	Sun	Mon	Tue	Wed	Thu	Fri	Sat
			1	2	3	4	30						1		1	2	3	4	5	6					1	2	3
5	6	7	8	9	10	11	2	3	4	5	6	7	8	7	8	9	10	11	12	13	4	5	6	7	8	9	10
12	13	14	15	16	17	18	9	10	11	12	13	14	15	14	15	16	17	18	19	20	11	12	13	14	15	16	17
19	20	21	22	23	24	25	16	17	18	19	20	21	22	21	22	23	24	25	26	27	18	19	20	21	22	23	24
26	27	28	29	30	31		23	24	25	26	27	28	29	28	29	30	31				25	26	27	28	29	30	31
September (九月) 24							October (十月) 24							November (十一月) 24							December (十二月) 24						
Sun	Mon	Tue	Wed	Thu	Fri	Sat	Sun	Mon	Tue	Wed	Thu	Fri	Sat	Sun	Mon	Tue	Wed	Thu	Fri	Sat	Sun	Mon	Tue	Wed	Thu	Fri	Sat
1	2	3	4	5	6	7			1	2	3	4	5				1	2	3	4	31					1	2
8	9	10	11	12	13	14	6	7	8	9	10	11	12	5	6	7	8	9	10	11	3	4	5	6	7	8	9
15	16	17	18	19	20	21	13	14	15	16	17	18	19	12	13	14	15	16	17	18	10	11	12	13	14	15	16
22	23	24	25	26	27	28	20	21	22	23	24	25	26	19	20	21	22	23	24	25	17	18	19	20	21	22	23
29	30						27	28	29	30	31			26	27	28	29	30			24	25	26	27	28	29	30

Dynamic Pricing Subject To Change - Limited Allotment / 价格有变动的可能 - 售完为止

A: Season Two Way Coach 来回车程	Low 淡季	Peak 旺季	Super 超旺	High 巅峰
Coach Price Per Pax 车票价每人	\$ 63	\$ 70	\$ 110	\$ 120
B: Season Room Package 客房配套				
Price Per Room Per Night + Daily Breakfast + 1 x SkyWay 每间客房每晚的价格 + 每日早餐 + 1 x 缆车服务				
Y5 Deluxe Room (2 Pax 两人一房)	\$ 120	\$ 170	\$ 180	\$ 218
Y5 Triple Room (2 Pax 两人一房)	\$ 130	\$ 180	\$ 190	\$ 228
Superior Deluxe Room (2 Pax 两人一房)	\$ 180	\$ 230	\$ 240	\$ 278
World Club Room (2 Pax 两人一房)	\$ 196	\$ 246	\$ 256	\$ 292

行程仅供参考, 最终行程可能会根据实际情况进行微调。须符合条规

The itinerary is for reference only, the final itinerary may be fine-tuned according to the actual situation. Terms Apply*

Genting Coach Schedule 云顶时间表

Departure 出发	Singapore 新加坡	Genting 云顶	Return 回程
6:40 AM	People's Park Centre 168 Coffee Shop 牛车水珍珠大厦 168咖啡店		12:00 PM 1:30 PM
9:45 AM 9:20 PM	Harbourfront Centre Coach Bay 港湾中心巴士巴士停车场		10:30 AM
7:20 AM 9:00 PM	Ban San Street / Queen Street 170 Bus Terminal 万山街 / 奎因街 170巴士总站		10:00 AM 12:20 PM
7:05 AM 9:15 PM	Boon Lay Shopping Centre 文礼购物中心		10:05 AM 12:15 PM
7:35 AM	Jurong East Genting Hotel Side Road 裕廊东 云顶酒店路旁		12:10 PM 1:30 PM
7:00 AM 9:15 AM 8:50 PM	Kovan Interchange Bus Stop 高文巴士转换站		10:30 AM 12:05 PM
Departure 出发	Johor Bharu 新山	Genting 云顶	Return 回程
7:30 AM 9:00 PM	Merlin / Tun Aminah/ Senai/ Sri Putri / Kulai / Johor Jaya 美伦大厦 / 皇后 / 公主 / 士乃 / 古来 / 柔佛再也		12:00 PM 3:30 PM
Departure 出发	Malacca 马六甲	Genting 云顶	Return 回程
10:05 AM	707 Hub / Estadia / Hatten Hotel Coach Bay / 马六甲雅胜/惠胜酒店巴士总站/707中心		12:00 PM 3:30 PM
Alight 抵达	Genting Hilltop Bus Terminal BT3 云顶山顶巴士总站 BT3		Return 回程

行程仅供参考, 最终行程可能会根据实际情况进行微调。须符合条规

The itinerary is for reference only, the final itinerary may be fine-tuned according to the actual situation. Terms Apply*

Interior 内部 (2 + 1) 27 - 30 Seater 座位



Coach Fleets 车队



Gold Class



Recline Seat



USB



Wifi



Air Suspensions

*****Free WIFI And USB Ports Are Available On Select Coaches Only.*****

We Are On The Verge Of Upgrading Our Coach Fleet. *Terms Applies Please Take Note : Product Images Are For Illustrative Purposes Only.

*****仅部分车厢提供免费 WIFI 和 USB 端口。*****

我们即将升级我们的客车车队。 *适用条款请注意：产品图片仅供说明之用。

行程仅供参考, 最终行程可能会根据实际情况进行微调。须符合条规

The itinerary is for reference only, the final itinerary may be fine-tuned according to the actual situation. Terms Apply*

Return From Genting 从云顶回

Board And Alight Same Location. Check In At Genting Hilltop Bus Terminal BT3 Approach 707-Inc Ground Crew In Uniforms or Holding Sign Boards For Bus Number. Present Your Voucher With Name, Date, Time, and Seat number To The Driver or Ground Crew Before Boarding.
在同一地点上车和下车。在云顶山顶巴士总站 BT3，请向穿着707制服或手持707标牌的工作人员询问巴士号码。在登机前向司机或地勤人员出示您的订单，其中包含姓名、日期、时间和座位号



www.707-inc.com

Check In
提早前往办理报到手续

15 Min

B

707 Genting Hilltop BT3 Bus Terminal
Board and Alight Point
云顶山顶 BT3 巴士总站
上下车地点



LEGEND 图例

Parking 停车场

Hilltop Bus Terminal 山顶巴士总站

Ground Transportation Hub 地面交通中心

C 707 Genting Outlet At First World Hotel Lobby
(Near Koong Woh Tong / Starbucks Coffee)
707 云顶柜台在第一大酒店大堂
靠近恭和堂 / 星巴克咖啡

707 Counter Beside Escalator 柜台电扶梯旁

The Only Bus Terminal In Genting Location / 云顶唯一的巴士总站

Hilltop Bus Terminal BT3 / Sky Avenue / Crockfords / First World Are The Same Location / 都在同一位置

707 Genting Outlet At First World Hotel Lobby (Near Koong Woh Tong)

顶柜台在第一大酒店大堂靠近恭和堂

Show & Events Redemption Counter
柜台领取演唱会或活动门票

Operation Hour 营业时间 10.00 AM to 3.30 PM*

707 Counter
Beside Escalator
柜台电扶梯旁



Near Koong Woh Tong /
Starbucks Coffee
靠近恭和堂 / 星巴克咖啡

行程仅供参考，最终行程可能会根据实际情况进行微调。须符合条款

The itinerary is for reference only, the final itinerary may be fine-tuned according to the actual situation. Terms Apply*



707-Inc Xpress



- **Coach Insurance**
- **Coach Transfer**
- **Hotel**
- **Travel Insurance**
- **Meals**
- **Hotel Tax**

Coach Insurance 巴士上保險 Policy Schedule

For The Benefit Of: Coach Passengers Of The Policyholder Departure <u>Singapore</u> / Return <u>Singapore</u> ONLY 有效:新加坡出发 / 返回新加坡	Maximum Benefit Limit Payable Per Insured Person \$ SGD Singapore Dollars
1. Accidental Death & Permanent Disablement * 80 Years Old Above Coverage \$12,500	\$ 25,000
2. Accidental Medical Expenses	\$ 2,000
3. Emergency Medical Evacuation	\$ 1,000
4. Loss Of Baggage Due To Thief, Burglary Or Robbery (Police Report Required) 需要警方报告	\$ 200

Coverage: Underwritten By Chubb Insurance.

NOT Valid For Malaysia Interstate Travelers

One Way \$5.00

Two Way \$10.00

行程仅供参考, 最终行程可能会根据实际情况进行微调。须符合条规

The itinerary is for reference only, the final itinerary may be fine-tuned according to the actual situation. Terms Apply*

How To Book:

RPG

PAYMENT METHODS

Reserved

Payment

Go

A : Cash / NETS At Outlets

707-Inc People's Park Centre - 10:00 AM – 7:00 PM

Address: 101, Upper Cross Street, People's Park Centre #B1-20, Singapore 058357

707-Inc Boon lay Shopping Centre - 10:00 AM – 7:00 PM

Address : 221, Boon lay Place , #01-104, Boon lay Shopping Centre, Singapore 640221

B : PayNow

Book Through Whatsapp Channel

C : PayNow & Credit Card

Online Reservation www.707-inc.com

- **Destination & Package Booking Details**
- **Travel Date & Time**
- **Name As Per Passport (CAP)**
- **IC Number / Passport Number**
- **Date Of Birth**
- **Genting Member Card No. Genting Only***

行程仅供参考, 最终行程可能会根据实际情况进行微调。须符合条规

The itinerary is for reference only, the final itinerary may be fine-tuned according to the actual situation. Terms Apply*

Confirmation Of Acceptance



By Booking With: 707-inc Great Excursion Travel Pte Ltd.
You Are Acknowledging That You Have Read Our Terms And Conditions
And You Agree To Be Bound By Them.

**General Terms and Conditions – Others Terms Applies Refer To www.707-inc.com/terms
707-Inc Great Excursion Travel Pte Ltd Is Refer Is Our Company.**

- Ticket / Tour Package Is Strictly NON-REFUNDABLE/NON-REROUTEABLE/NON TRANSFERRABLE/NO AMENDMENTS. No Show On Booked Dates Will Render Services Forfeited. Suggest Buy Travel Insurance.

Hotel Regulations

- Hotel Standard Check In Time Is At 3:00 PM And The Standard Check-out Time Is 11:00 AM By Passport - Exclude Sustainability and Tourism Tax Per Room Per Night (Pay RM Upon Check-In).
- Room Type Is Assign By Hotels Strictly No Request. Overlap & Platinum Card Booking Will Be REJECTED. One Member Card Can Book Only Once Per Date.
- Early Check-in Is Subject To Room Availability And Surcharge. Late Checkouts Will Automatically Charge One (1) Night.
- All Room Categories (Bed Configuration) And Special Requests Are Subject To Availability Upon Check-in
- Damage And Loss Of Hotel Key Cards, Bedsheets And Towels, And Consumption Of Food And Drinks In The Mini-fridge-bar And Other Incidental Expenses Are NOT Included In The Tour/Travel Package & These Are Charged To The Client.
- Incidental Charge: Most Of The Hotels Are Requiring Security Deposit Upon Check-in. Return Of Deposit Will Be Processed Upon Check Out If No Damages Have Been Incurred During Your Stay.

行程仅供参考, 最终行程可能会根据实际情况进行微调。须符合条规

The itinerary is for reference only, the final itinerary may be fine-tuned according to the actual situation. Terms Apply*

First World Hotel

第一大酒店



World's largest hotel with the best value

The world's largest hotel offers an astronomical 7,351 rooms, a wide selection to spoil travellers of every budget.

First World Hotel is situated at the heart of Resorts World Genting, giving guests easy access to key locations such as the First World Plaza, SkyAvenue, Skytropolis Indoor Theme Park, and Genting International Convention Centre.

Picture For Illustration Only 图片仅供参考

行程仅供参考, 最终行程可能会根据实际情况进行微调。须符合条规

The itinerary is for reference only, the final itinerary may be fine-tuned according to the actual situation. Terms Apply*



First World Hotel Standard Room

Ideal For Two Adults Only



Features

- **No frills, practical, compact room**
- **Ideal for two adults only**
- **WiFi coverage at lobby level only, upon purchase at Information Counter**
- **Located at Tower 1**
- **Average room size: 180 sq. ft.**

Amenities

- **In-room safe**
- **Telephone**
- **Standing shower**
- **Hair dryer**
- **Three-in-one shampoo**
- **Hot and cold water dispenser located along floor corridor**
- **Not provided in room - Toiletry set, mineral water, coffee and tea sachet can be purchased at the vending machine located at the lobby lift landing**

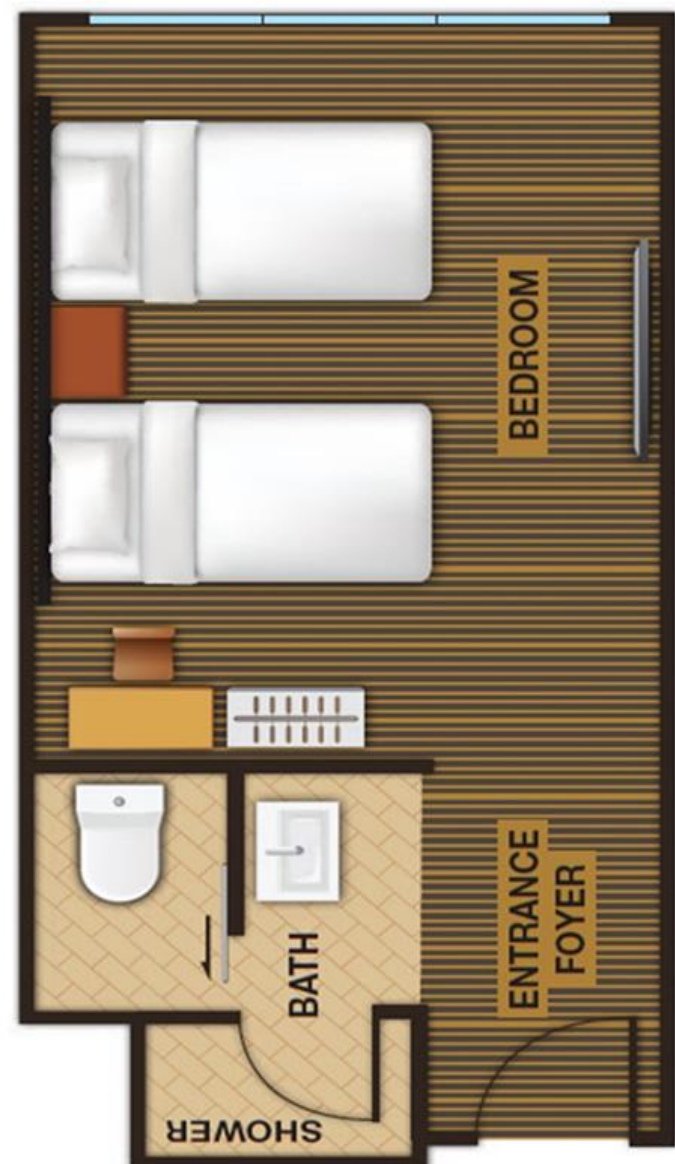

Picture For Illustration Only 图片仅供参考

行程仅供参考, 最终行程可能会根据实际情况进行微调。须符合条规

The itinerary is for reference only, the final itinerary may be fine-tuned according to the actual situation. Terms Apply*



First World Hotel Deluxe Room With Mini Fridge Ideal For Two Adults Only



Features

- **No frills, practical, compact room**
- **Ideal for two adults only**
- **WiFi coverage at lobby level only, upon purchase at Information Counter**
- **Located at Tower 2**
- **Average room size: 180 sq. ft.**

Amenities

- **In-room safe**
- **Flat screen TV**
- **Telephone**
- **Standing shower**
- **Hair dryer**
- **Tea and coffee-making facilities**
- **3-in 1 Liquid Soap**
- **Kettle**
- **Mini fridge**
- **Not provided in room -Toiletry set, mineral water, coffee and tea sachet can be purchased at the vending machine located at the lobby lift landing**



Picture For Illustration Only 图片仅供参考

行程仅供参考, 最终行程可能会根据实际情况进行微调。须符合条规

The itinerary is for reference only, the final itinerary may be fine-tuned according to the actual situation. Terms Apply*



First World Hotel Triple Room

With Mini Fridge Ideal For Two Or Three Adults Only



Features

- No frills, practical, compact room
- Ideal for two or three adults
- WiFi coverage at lobby level only, upon purchase at Information Counter
- Located at Tower 2
- Average room size: 180 sq. ft.

Amenities

- In-room safe
- Flat screen TV
- Telephone
- Standing shower
- Hair dryer
- Tea and coffee-making facilities
- 3-in 1 Liquid Soap
- Kettle
- Mini fridge
- Not provided in room -Toiletry set, mineral water, coffee and tea sachet can be purchased at the vending machine located at the lobby lift landing



Picture For Illustration Only 图片仅供参考

行程仅供参考, 最终行程可能会根据实际情况进行微调。须符合条规

The itinerary is for reference only, the final itinerary may be fine-tuned according to the actual situation. Terms Apply*



First World Hotel Y5 Deluxe Room

With Mini Fridge Ideal For Two Adults Only



Features

- No frills, practical, compact room
- Chic and trendy room design
- Ideal for two adults only
- Located at Tower 3
- Average room size: 180 sq. ft

Amenities

- In-room safe
- Flat screen TV
- Telephone
- Standing shower
- Hair dryer
- Tea and coffee-making facilities
- Kettle
- 3-in 1 Liquid Soap and Bar Soap
- Mini fridge
- Free Wi-Fi
- Not provided in room -Toiletry set, mineral water, coffee and tea sachet can be purchased at the vending machine located at the lobby lift landing

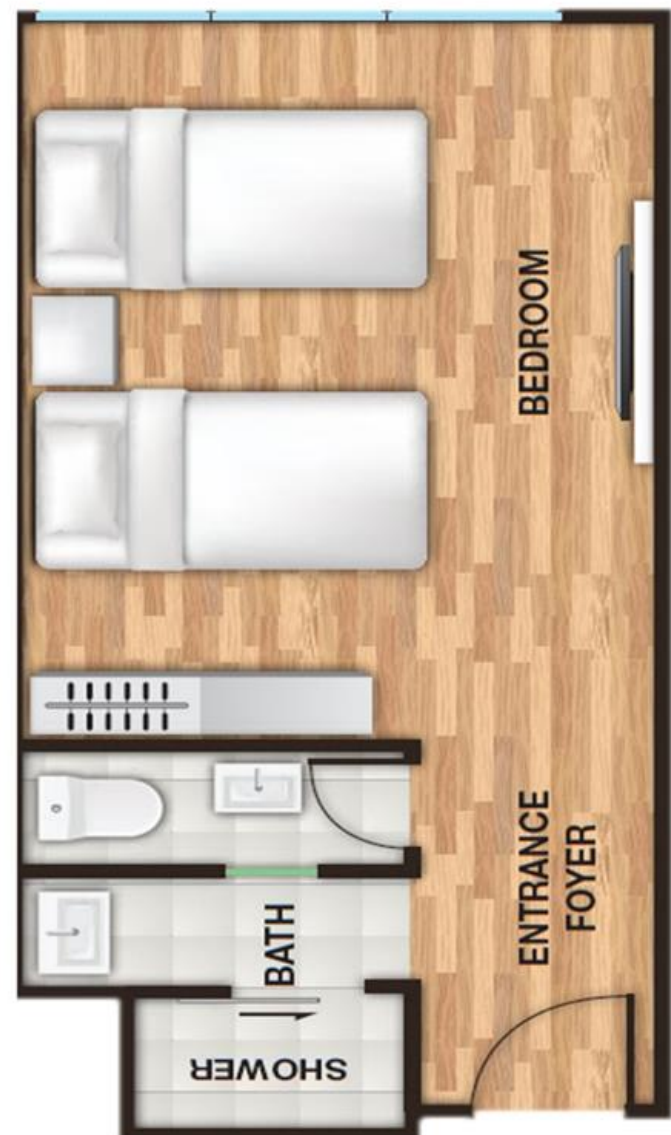

Picture For Illustration Only 图片仅供参考

行程仅供参考, 最终行程可能会根据实际情况进行微调。须符合条规

The itinerary is for reference only, the final itinerary may be fine-tuned according to the actual situation. Terms Apply*



First World Hotel Y5 Triple Room

With Mini Fridge Ideal For Two Or Three Adults Only



Features

- No frills, practical, compact room
- Chic, trendy room design
- Ideal for two or three adults
- Located at Tower 3
- Average room size: 170 sq. ft

Amenities

- In-room safe
- Flat screen TV
- Telephone
- Standing shower
- Hair dryer
- Tea and coffee-making facilities
- Kettle
- 3-in 1 Liquid Soap and Bar Soap
- Mini fridge
- Free Wi-Fi
- Not provided in room -Toiletry set, mineral water, coffee and tea sachet can be purchased at the vending machine located at the lobby lift landing

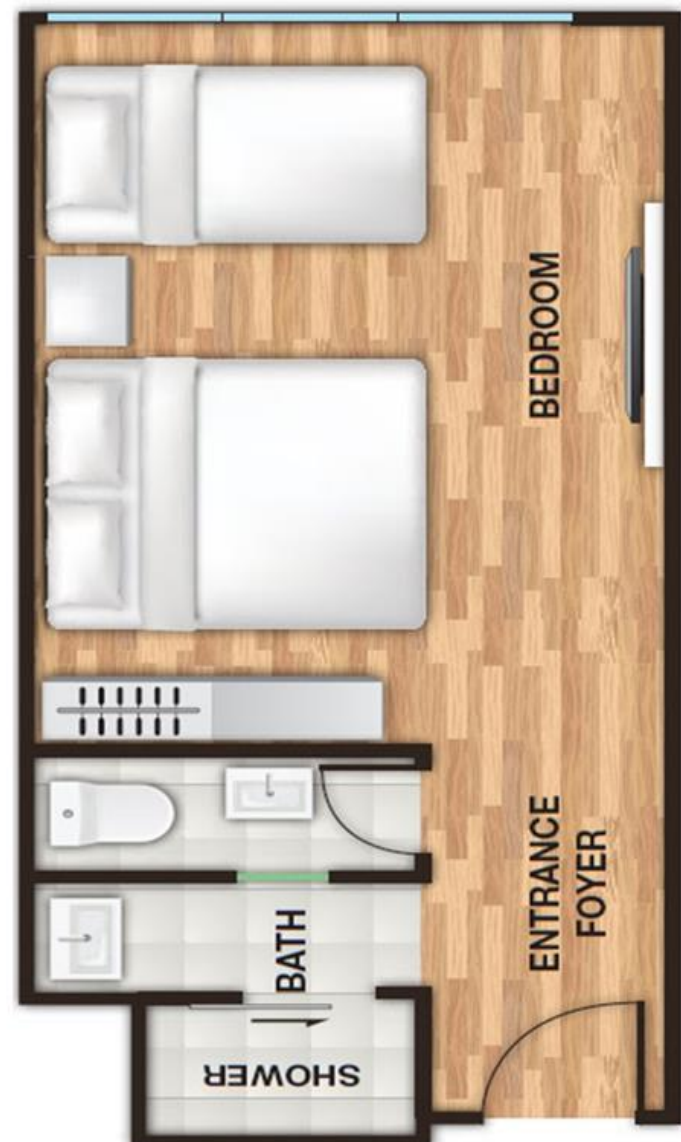

Picture For Illustration Only 图片仅供参考

行程仅供参考, 最终行程可能会根据实际情况进行微调。须符合条规

The itinerary is for reference only, the final itinerary may be fine-tuned according to the actual situation. Terms Apply*



First World Hotel Superior Deluxe Room

With Mini Fridge Ideal For Two Adults Only



Features

- No frills, practical, compact room
- Ideal for two adults
- WiFi coverage at lobby level only, upon purchase at Information Counter
- Located at Tower 2
- Average room size: 320 sq. ft.

Amenities

- In-room safe
- Flat screen TV
- Telephone
- Bathtub or standing shower
- Hair dryer
- Tea and coffee-making facilities
- Kettle
- Mini fridge
- 3-in 1 Liquid Soap
- Complimentary mineral water
- Coffee table and sofa

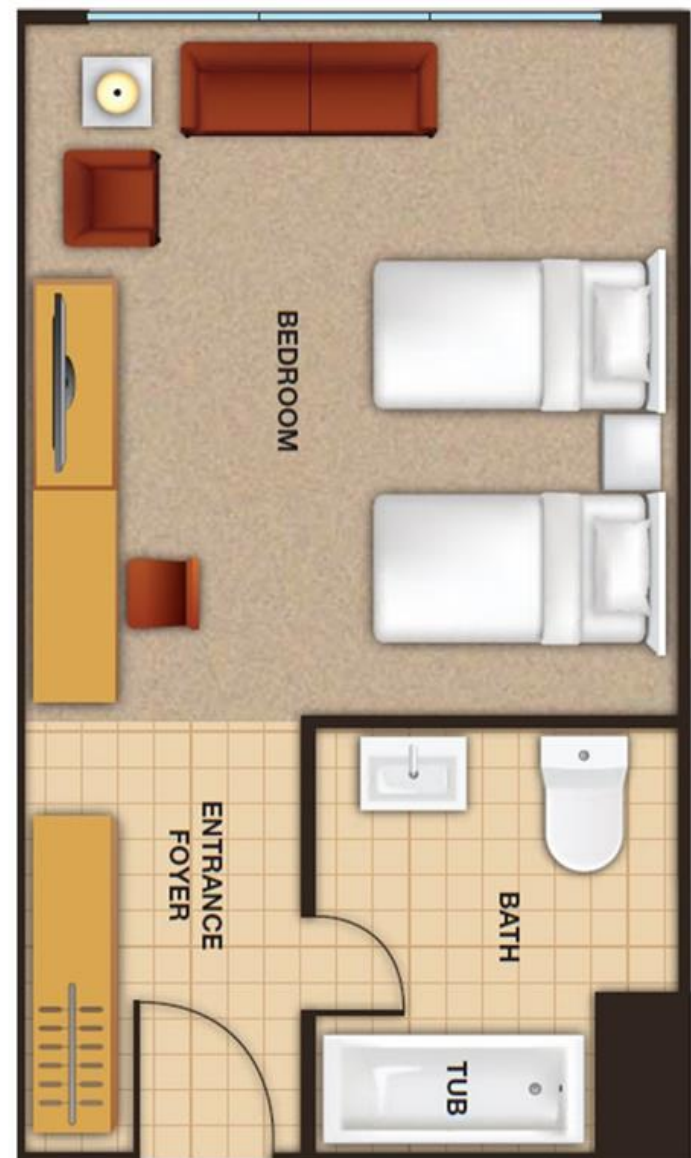

Picture For Illustration Only 图片仅供参考

行程仅供参考, 最终行程可能会根据实际情况进行微调。须符合条规

The itinerary is for reference only, the final itinerary may be fine-tuned according to the actual situation. Terms Apply*



First World Hotel World Club Room

With Living Space Ideal For Two Adults Only



Features

- **Spacious room with affordable luxury**
- **Ideal for two adults only**
- **Wifi coverage at lobby level only, upon purchase at Information Counter**
- **Average room size: 430 sq. ft.**

Amenities

- **In-room safe**
- **Flat screen TV**
- **Telephone**
- **Standing shower**
- **Hair dryer**
- **Tea and coffee-making facilities**
- **Kettle**
- **Mini fridge**
- **Toiletries provided**
- **Complimentary mineral water**
- **Coffee table and two-seater sofa**



Picture For Illustration Only 图片仅供参考

行程仅供参考, 最终行程可能会根据实际情况进行微调。须符合条规

The itinerary is for reference only, the final itinerary may be fine-tuned according to the actual situation. Terms Apply*



First World Hotel World Club Room 2

With Living Space Ideal For Two To Four Adults Only



Features

- **Spacious room with affordable luxury**
- **Ideal for two or four adults**
- **Wifi coverage at lobby level only, upon purchase at Information Counter**
- **Average room size: 430 sq. ft.**

Amenities

- **In-room safe**
- **Flat screen TV**
- **Telephone**
- **Mini Fridge**
- **Bath tub and Standing shower**
- **Hair dryer**
- **Tea and coffee-making facilities**
- **Kettle**
- **Toiletries provided**
- **Complimentary mineral water**
- **Coffee table and two-seater sofa**



Picture For Illustration Only 图片仅供参考

行程仅供参考, 最终行程可能会根据实际情况进行微调。须符合条规

The itinerary is for reference only, the final itinerary may be fine-tuned according to the actual situation. Terms Apply*



Genting 云顶

Place Of Interests

Skytropolis Indoor Theme Park
SkyWorlds outdoor Theme Park
Awana SkyWay
Genting Entertainment Facility
BigTop Video Games Park
Vision City Video Games Park
Sky VR
Genting Snow World
Ripley's Believe It Or Not
Genting Bowl

好玩景点

天城室内主题乐园
 天城世界主题乐园
 云天缆车
 云顶娱乐设施
 大本营电玩城
 梦幻电玩城
Sky VR
 云顶雪世界
 云顶信不信由你
 云顶保龄球场

Surrounding Explore

Chin Swee Caves Temple
Lim Goh Tong Memorial Hall
Genting Strawberry Leisure Farm
Gohtong Jaya
World of Phalaenopsis
Happy Bee Farm
Awana Horse Ranch

外围探索

清水岩庙
 林梧桐纪念馆
 云顶草莓园
 梧桐再也
 蝴蝶兰世界
 蜜蜂园
 牧马场

Food & Night Life Explore

Malaysian Food Street
Jom Makan Street Food
Genting Garden Hotpot
Starbucks Coffee
Han's Cha Chaa Teng
Burger & Lobster
Five Guys
Motorino Pizzeria
The Laughing Fish by Harry Ramsden
High Line
FUHU Restaurant
Zouk Genting
Cloud 9 Casual bar
Redtail Karaoke

美食与夜生活探索

马来西亚美食街
Jom Makan美食街
 云顶花园火锅
 星巴克咖啡
 汉记茶餐厅
 天台休闲美食街
 福虎餐厅
Zouk 夜店
Cloud 9 休闲酒吧
 卡拉ok

Shopping & Relax

SkyAvenue Complex
First World Complex
Genting Grand Complex
Genting Premium Outlets
Awana SkyCentral

购物与放松

云天综合大楼
 第一综合大楼
 云豪综合大楼
 云顶名牌折扣购物中心

行程仅供参考, 最终行程可能会根据实际情况进行微调。须符合条规

The itinerary is for reference only, the final itinerary may be fine-tuned according to the actual situation. Terms Apply*



Theme Park Ticket Available

提供主题公园门票

~ Sold Separately 单独出售 ~



行程仅供参考, 最终行程可能会根据实际情况进行微调。须符合条规

The itinerary is for reference only, the final itinerary may be fine-tuned according to the actual situation. Terms Apply*