

Genting ITOUR Package

云顶 | 旅游配套

First

World Hotel

Open Dated Theme Park Tickets
日期开放式主题公园门票

FLASH

SALE



Business Account

WhatsApp +65 8710 7707

www.707-inc.com

Favored ★★★★★ Sold 168 888

所提供的行程及价格仅供参考，最终行程可能根据实际情况进行调整。受条款及细则约束。*

The provided itinerary and price are for reference purposes only; the final itinerary may be adjusted based on the actual circumstances. Terms and conditions apply. *

First World Hotel

第一大酒店

Y5 Deluxe Room



Y5 Triple Room



Superior Deluxe Room



Standard / Deluxe Room



Package Include 配套包括:

Two Way Coach : Singapore Genting Singapore

来回车程: 新加坡 - 云顶 - 新加坡

Stay At Hotel (Twin)

入住酒店 (两人一房)



Cable Car Return Transfer Once Only (02 Pax)

一趟来回缆车服务 (两人)

Daily Buffet Breakfast at Coffee Terrace (02 Pax)

每日自助早餐于 **Coffee Terrace** (两人)

Open Dated Theme Park Tickets \$39 日期开放式主题公园门票

行程仅供参考, 最终行程可能会根据实际情况进行微调。须符合条规

The itinerary is for reference only, the final itinerary may be fine-tuned according to the actual situation. Terms Apply*

Simple Step To Quote 报价步骤

Step 1 : Select Your Bus 选择您的巴士

(Child Below 2 Years Old No Seat Required 2岁以下儿童无需座位)

- One Way 单程
- Two Way Return 返回

Step 2 : Select A Room Type 选择您的房型

- Hotel Room Type 酒店房型

Step 3 : Select Your Check In Date 选择您的入住日期

- Base On Colour Season, Per Room Per Night.
- 以颜色区分季节, 每房每晚为准

Step 4 : To Book Provide Detail 预订提供以下资料

Number Of Travelers 出发人数

Hotel Name 酒店名

Check In Date 入住日期

Check Out Date 退房日期

Number Of Hotel Room 酒店房间数量

Bus Date & Timing AM / PM 巴士日期发车时间上午/下午

Remark 备注

- Dynamic Pricing Subject To Change, Limited Allotment 价格有变动的可能,售完为止
- Exclude Tourism & Sustainability Tax, Security Deposit & Travel Insurance
不含旅游税&可持续发展税,押金和旅游保险
- Booking Is Subjected To Availability & Confirmation 一切预订以最终确认书为准
- Terms & Condition Apply 需符合条规

所提供的行程及价格仅供参考, 最终行程可能根据实际情况进行调整。受条款及细则约束。*

The provided itinerary and price are for reference purposes only; the final itinerary may be adjusted based on the actual circumstances. Terms and conditions apply. *

Step 1 : Select Your Bus 选择您的巴士 (Example 例子)

(Child Below 2 Years Old No Seat Required 2岁以下儿童无需座位)

One Way Sin - Genting 单程新 - 云 (03 Mar 25 Mon) 1 Pax X \$36 = \$36

One Way Return Genting - Sin 返回云 - 新 (05 Mar 25 Wed) 1 Pax X \$27 = \$27

Two Way Return 往返新 - 云 - 新 1 Pax = (\$36 + \$27 = \$63)

January / February / March 2025 一月 / 二月 / 三月

January 一月				February 二月				March 三月			
Date 日期		Sin 新加坡 - Genting 云顶	Genting 云顶 - Sin 新加坡	Date 日期		Sin 新加坡 - Genting 云顶	Genting 云顶 - Sin 新加坡	Date 日期		Sin 新加坡 - Genting 云顶	Genting 云顶 - Sin 新加坡
1	Wed			1	Sat	\$36	\$50*	1	Sat	\$36	\$27
2	Thu			2	Sun	\$36	\$55*	2	Sun	\$36	\$32
3	Fri			3	Mon	\$36	\$27	3	Mon	\$36	\$27
4	Sat			4	Tue	\$36	\$27	4	Tue	\$36	\$27
5	Sun			5	Wed	\$36	\$27	5	Wed	\$36	\$27
6	Mon			6	Thu	\$36	\$27	6	Thu	\$36	\$27
7	Tue			7	Fri	\$43	\$27	7	Fri	\$43	\$27
8	Wed			8	Sat	\$36	\$27	8	Sat	\$36	\$27
9	Thu			9	Sun	\$36	\$32	9	Sun	\$36	\$32
10	Fri			10	Mon	\$36	\$27	10	Mon	\$36	\$27
11	Sat			11	Tue	\$36	\$27	11	Tue	\$36	\$27
12	Sun			12	Wed	\$36	\$27	12	Wed	\$36	\$27
13	Mon			13	Thu	\$36	\$27	13	Thu	\$36	\$27
14	Tue			14	Fri	\$43	\$27	14	Fri	\$43	\$27
15	Wed			15	Sat	\$36	\$27	15	Sat	\$36	\$27
16	Thu			16	Sun	\$36	\$32	16	Sun	\$36	\$32
17	Fri			17	Mon	\$36	\$27	17	Mon	\$36	\$27
18	Sat			18	Tue	\$36	\$27	18	Tue	\$36	\$27
19	Sun			19	Wed	\$36	\$27	19	Wed	\$36	\$27
20	Mon			20	Thu	\$36	\$27	20	Thu	\$36	\$27
21	Tue			21	Fri	\$43	\$27	21	Fri	\$43	\$27
22	Wed			22	Sat	\$36	\$27	22	Sat	\$36	\$27
23	Thu			23	Sun	\$36	\$32	23	Sun	\$36	\$32
24	Fri			24	Mon	\$36	\$27	24	Mon	\$36	\$27
25	Sat			25	Tue	\$36	\$27	25	Tue	\$36	\$27
26	Sun			26	Wed	\$36	\$27	26	Wed	\$36	\$27
27	Mon			27	Thu	\$36	\$27	27	Thu	\$36	\$27
28	Tue			28	Fri	\$43	\$27	28	Fri	\$50*	\$27
29	Wed							29	Sat	\$36	\$27
30	Thu							30	Sun	\$36	\$32*
31	Fri							31	Mon	\$36	\$38*

* 所提供的行程及价格仅供参考，最终行程可能根据实际情况进行调整。受条款及细则约束。

* The provided itinerary and price are for reference purposes only; the final itinerary may be adjusted based on the actual circumstances. Terms and conditions apply.

Step 1 : Select Your Bus 选择您的巴士 (Example 例子)

(Child Below 2 Years Old No Seat Required 2岁以下儿童无需座位)

One Way Sin - Genting 单程新 - 云 (02 Jun 25 Mon) 1 Pax X \$36 = \$36

One Way Return Genting - Sin 返回云 - 新 (05 Jun 25 Wed) 1 Pax X \$27 = \$27

Two Way Return 往返新 - 云 - 新 1 Pax = (\$36 + \$27 = \$63)

April / May / June 2025 四月 / 五月 / 六月

April 四月				May 五月				June 六月			
Date 日期		Sin 新加坡 - Genting 云顶	Genting 云顶 - Sin 新加坡	Date 日期		Sin 新加坡 - Genting 云顶	Genting 云顶 - Sin 新加坡	Date 日期		Sin 新加坡 - Genting 云顶	Genting 云顶 - Sin 新加坡
1	Tue	\$36	\$27	1	Thu	\$36	\$27	1	Sun	\$36	\$32
2	Wed	\$36	\$27	2	Fri	\$43	\$27	2	Mon	\$36	\$27
3	Thu	\$36	\$27	3	Sat	\$36	\$27	3	Tue	\$36	\$27
4	Fri	\$43	\$27	4	Sun	\$36	\$32	4	Wed	\$36	\$27
5	Sat	\$36	\$27	5	Mon	\$36	\$27	5	Thu	\$36	\$27
6	Sun	\$36	\$32	6	Tue	\$36	\$27	6	Fri	\$45*	\$27
7	Mon	\$36	\$27	7	Wed	\$36	\$27	7	Sat	\$45*	\$27
8	Tue	\$36	\$27	8	Thu	\$36	\$27	8	Sun	\$36	\$32*
9	Wed	\$36	\$27	9	Fri	\$45*	\$27	9	Mon	\$36	\$27
10	Thu	\$36	\$27	10	Sat	\$45*	\$27	10	Tue	\$36	\$27
11	Fri	\$43	\$27	11	Sun	\$36	\$32*	11	Wed	\$36	\$27
12	Sat	\$36	\$27	12	Mon	\$36	\$36*	12	Thu	\$36	\$27
13	Sun	\$36	\$32	13	Tue	\$36	\$27	13	Fri	\$43	\$27
14	Mon	\$36	\$27	14	Wed	\$36	\$27	14	Sat	\$36	\$27
15	Tue	\$36	\$27	15	Thu	\$36	\$27	15	Sun	\$36	\$32
16	Wed	\$36	\$27	16	Fri	\$43	\$27	16	Mon	\$36	\$27
17	Thu	\$45*	\$27	17	Sat	\$36	\$27	17	Tue	\$36	\$27
18	Fri	\$45*	\$27	18	Sun	\$36	\$32	18	Wed	\$36	\$27
19	Sat	\$36	\$27	19	Mon	\$36	\$27	19	Thu	\$36	\$27
20	Sun	\$36	\$40*	20	Tue	\$36	\$27	20	Fri	\$43	\$27
21	Mon	\$36	\$27	21	Wed	\$36	\$27	21	Sat	\$36	\$27
22	Tue	\$36	\$27	22	Thu	\$36	\$27	22	Sun	\$36	\$32
23	Wed	\$36	\$27	23	Fri	\$43	\$27	23	Mon	\$36	\$27
24	Thu	\$36	\$27	24	Sat	\$36	\$27	24	Tue	\$36	\$27
25	Fri	\$43	\$27	25	Sun	\$36	\$32	25	Wed	\$36	\$27
26	Sat	\$36	\$27	26	Mon	\$36	\$27	26	Thu	\$36	\$27
27	Sun	\$36	\$32	27	Tue	\$36	\$27	27	Fri	\$43	\$27
28	Mon	\$36	\$27	28	Wed	\$36	\$27	28	Sat	\$36	\$27
29	Tue	\$36	\$27	29	Thu	\$36	\$27	29	Sun	\$36	\$32
30	Wed	\$36	\$27	30	Fri	\$43	\$27	30	Mon	\$36	\$27
				31	Sat	\$36	\$27				

* 所提供的行程及价格仅供参考，最终行程可能根据实际情况进行调整。受条款及细则约束。

* The provided itinerary and price are for reference purposes only; the final itinerary may be adjusted based on the actual circumstances. Terms and conditions apply.

Step 1 : Select Your Bus 选择您的巴士 (Example 例子)

(Child Below 2 Years Old No Seat Required 2岁以下儿童无需座位)

One Way Sin - Genting 单程新 - 云 (01 Sep 25 Mon) 1 Pax X \$36 = \$36

One Way Return Genting - Sin 返回云 - 新 (03 Sep 25 Wed) 1 Pax X \$27 = \$27

Two Way Return 往返新 - 云 - 新 1 Pax = (\$36 + \$27 = \$63)

July / August / September 2025 七月 / 八月 / 九月

July 七月				August 八月				September 九月			
Date 日期		Sin 新加坡 - Genting 云顶	Genting 云顶 - Sin 新加坡	Date 日期		Sin 新加坡 - Genting 云顶	Genting 云顶 - Sin 新加坡	Date 日期		Sin 新加坡 - Genting 云顶	Genting 云顶 - Sin 新加坡
1	Tue	\$36	\$27	1	Fri	\$43	\$27	1	Mon	\$36	\$27
2	Wed	\$36	\$27	2	Sat	\$36	\$27	2	Tue	\$36	\$27
3	Thu	\$36	\$27	3	Sun	\$36	\$32	3	Wed	\$36	\$27
4	Fri	\$43	\$27	4	Mon	\$36	\$27	4	Thu	\$36	\$27
5	Sat	\$36	\$27	5	Tue	\$36	\$27	5	Fri	\$43	\$27
6	Sun	\$36	\$32	6	Wed	\$36	\$27	6	Sat	\$36	\$27
7	Mon	\$36	\$27	7	Thu	\$36	\$27	7	Sun	\$36	\$32
8	Tue	\$36	\$27	8	Fri	\$43	\$27	8	Mon	\$36	\$27
9	Wed	\$36	\$27	9	Sat	\$36	\$27	9	Tue	\$36	\$27
10	Thu	\$36	\$27	10	Sun	\$36	\$32	10	Wed	\$36	\$27
11	Fri	\$43	\$27	11	Mon	\$36	\$27	11	Thu	\$36	\$27
12	Sat	\$36	\$27	12	Tue	\$36	\$27	12	Fri	\$43	\$27
13	Sun	\$36	\$32	13	Wed	\$36	\$27	13	Sat	\$36	\$27
14	Mon	\$36	\$27	14	Thu	\$36	\$27	14	Sun	\$36	\$32
15	Tue	\$36	\$27	15	Fri	\$43	\$27	15	Mon	\$36	\$27
16	Wed	\$36	\$27	16	Sat	\$36	\$27	16	Tue	\$36	\$27
17	Thu	\$36	\$27	17	Sun	\$36	\$32	17	Wed	\$36	\$27
18	Fri	\$43	\$27	18	Mon	\$36	\$27	18	Thu	\$36	\$27
19	Sat	\$36	\$27	19	Tue	\$36	\$27	19	Fri	\$43	\$27
20	Sun	\$36	\$32	20	Wed	\$36	\$27	20	Sat	\$36	\$27
21	Mon	\$36	\$27	21	Thu	\$36	\$27	21	Sun	\$36	\$32
22	Tue	\$36	\$27	22	Fri	\$43	\$27	22	Mon	\$36	\$27
23	Wed	\$36	\$27	23	Sat	\$36	\$27	23	Tue	\$36	\$27
24	Thu	\$36	\$27	24	Sun	\$36	\$32	24	Wed	\$36	\$27
25	Fri	\$43	\$27	25	Mon	\$36	\$27	25	Thu	\$36	\$27
26	Sat	\$36	\$27	26	Tue	\$36	\$27	26	Fri	\$43	\$27
27	Sun	\$36	\$32	27	Wed	\$36	\$27	27	Sat	\$36	\$27
28	Mon	\$36	\$27	28	Thu	\$36	\$27	28	Sun	\$36	\$32
29	Tue	\$36	\$27	29	Fri	\$43	\$27	29	Mon	\$36	\$27
30	Wed	\$36	\$27	30	Sat	\$36	\$27	30	Tue	\$36	\$27
31	Thu	\$36	\$27	31	Sun	\$36	\$32				

* 所提供的行程及价格仅供参考，最终行程可能根据实际情况进行调整。受条款及细则约束。

* The provided itinerary and price are for reference purposes only; the final itinerary may be adjusted based on the actual circumstances. Terms and conditions apply.

Step 2 / 3 : Select A Room Type / Check In Date

选择您的房型 / 选择您的入住日期

➤ Hotel Room Type 酒店房型

➤ Base On Color Season, Per Room Per Night. 以颜色区分季节, 每房每晚为准

February (二月) 2025							March (三月) 2025							April (四月) 2025						
Sun	Mon	Tue	Wed	Thu	Fri	Sat	Sun	Mon	Tue	Wed	Thu	Fri	Sat	Sun	Mon	Tue	Wed	Thu	Fri	Sat
						1	30	31					1			1	2	3	4	5
2	3	4	5	6	7	8	2	3	4	5	6	7	8	6	7	8	9	10	11	12
9	10	11	12	13	14	15	9	10	11	12	13	14	15	13	14	15	16	17	18	19
16	17	18	19	20	21	22	16	17	18	19	20	21	22	20	21	22	23	24	25	26
23	24	25	26	27	28		23	24	25	26	27	28	29	27	28	29	30			

May (五月) 2025							June (六月) 2025							July (七月) 2025						
Sun	Mon	Tue	Wed	Thu	Fri	Sat	Sun	Mon	Tue	Wed	Thu	Fri	Sat	Sun	Mon	Tue	Wed	Thu	Fri	Sat
				1	2	3	1	2	3	4	5	6	7			1	2	3	4	5
4	5	6	7	8	9	10	8	9	10	11	12	13	14	6	7	8	9	10	11	12
11	12	13	14	15	16	17	15	16	17	18	19	20	21	13	14	15	16	17	18	19
18	19	20	21	22	23	24	22	23	24	25	26	27	28	20	21	22	23	24	25	26
25	26	27	28	29	30	31	29	30						27	28	29	30	31		

Price Per Room Per Night + Daily Breakfast + 1 x Cable Car

每间客房每晚的价格 + 每日早餐 + 1 x 缆车服务

Standard Room (Tower 1) (2 Pax 两人一房)	\$ 78	\$ 108	\$ 118	\$ 128
Deluxe Room (Tower 2) (2 Pax 两人一房)	\$ 88	\$ 118	\$ 128	\$ 138
Y5 Deluxe Room (Tower 3) (2 Pax 两人一房)	\$ 98	\$ 138	\$ 148	\$ 158
Y5 Triple Room (Tower 3) (2 Pax 两人一房)	\$ 126	\$ 166	\$ 176	\$ 186
Superior Deluxe (Tower 2) (2 Pax 两人一房)	\$ 138	\$ 182	\$ 192	\$ 202

Example 例子 1 : First World Hotel – Y5 Deluxe (Entitlement For 2 Pax 两人一房)

Departure 出发: [09/06/25](#)

Coach 巴士 + Hotel 酒店: 3 Days 天 2 Nights 夜 - (2 Pax 人 + 1 Room 房)

Total Bus Fare 车费: 2 Pax 人 (SIN 新 – GEN 云) \$72 + (GEN 云- SIN 新) \$54 = \$126 *

Total Room Fare 总房费: 1 Room 房 \$98 + \$98 = \$196 *

Grand Total 总数: \$126 * + \$196 * = \$322 or Average 平均 \$161 * Per Pax 每人

所提供的行程及价格仅供参考, 最终行程可能根据实际情况进行调整。受条款及细则约束。*

The provided itinerary and price are for reference purposes only; the final itinerary may be adjusted based on the actual circumstances. Terms and conditions apply. *

Genting Coach Schedule - Daily Departure

云顶 - 时间表每日出发

Singapore To Genting 新加坡去云顶	Singapore SG 新加坡 ↔ Genting MY 云顶	Genting Singapore 云顶去新加坡
	Alight 下车: Genting Main Terminal (Hilltop)	
	*Alight 下车: Resort World Awana Lobby - Fr Harbourfront	
6.40 AM	People's Park Centre (168 Coffee Shop) 牛车水珍珠大厦 (168 咖啡店)	12.00 PM 3.15 PM
7.00 AM 9.10 PM	Kovan (Interchange Bus Terminal) 高文 (巴士转换站)	10.45 AM 12.05 PM
7.20 AM 9:00 PM	Ban San Street / Queen Street (170 Bus Terminal) 万山街 / 奎因街 (170 巴士总站)	10.00 AM 12.20 PM
7.05 AM 10.25 AM 9.15 PM	Boon Lay Shopping Centre (Savoy Theatre) 文礼购物中心 (Savoy Theatre)	10.05 AM 12.15 PM
7.35 AM	Jurong East Genting Hotel (Side Road) 裕廊东云顶酒店 (路旁)	10.45 AM 12.10 PM
8.00 AM 10.10 AM 9.40 PM	Harbourfront Centre (Coach Bay 1 2 3) 港湾中心 (巴士停车场 1 2 3)	10.15 AM 12.10 PM
6.10 AM	Choa Chu Kang MRT Exit C (Pick Up Bay No.5) *(RW)* 蔡厝港地铁站出口 C (巴士车站 5 号)	1.30 PM
6.30 AM 9.45 PM	Jurong East MRT Exit B (Venture Ave Bus Bay No.5) *(RW)* 裕廊东地铁站出口 B (巴士车站 5 号)	1.30 PM
5.30 AM 9.00 PM	Tampines MRT Exit B (Bicycle Park) *(RW)* 淡滨尼地铁站出口 B (脚踏车站)	11.30 AM 1.00 PM
6.00 AM 10.00 AM 9.30 PM	Yishun MRT Exit B (Bicycle Park - Pick Up Point) *(RW)* 义顺地铁站出口 B (脚踏车站 - 接送点)	11.30 AM 1.00 PM
5.45 AM 9.40 AM 9.15 PM	Sengkang - Compass One (G16 Taxi Stand) *(RW)* 盛港 - 勘宝坊 - 1号 (G16 德士站)	11.30 AM 1.00 PM
5.50 AM	Ang Mo Kio (Bus Stop Infront Of Block 710) *(RW)* 宏茂桥第 710 座前面的巴士站	1.00 PM
Malacca To Genting 马六甲去云顶	Malacca MY 马六甲 ↔ Genting MY 云顶	Genting To Malacca 云顶去马六甲
	Alight 下车: Genting Main Terminal (Hilltop)	
10.05 AM	707 Hub / Estadia / Hatten Hotel Coach Bay 马六甲 707 中心 / 雅胜 / 惠胜酒店巴士总站	11.00 AM 3.30 PM

所提供的行程及价格仅供参考，最终行程可能根据实际情况进行调整。受条款及细则约束。*

The provided itinerary and price are for reference purposes only; the final itinerary may be adjusted based on the actual circumstances. Terms and conditions apply. *

Interior 内部 (2 + 1) 27 - 30 Seater 座位



Coach Fleets 车队



Gold Class



Recline Seat



USB



Wifi



Air Suspensions

*****Free WIFI And USB Ports Are Available On Select Coaches Only.*****

We Are On The Verge Of Upgrading Our Coach Fleet. *Terms Applies Please Take Note : Product Images Are For Illustrative Purposes Only.

*****仅部分车厢提供免费 WIFI 和 USB 端口。*****

我们即将升级我们的客车车队。 *适用条款请注意：产品图片仅供说明之用。

行程仅供参考, 最终行程可能会根据实际情况进行微调。须符合条规

The itinerary is for reference only, the final itinerary may be fine-tuned according to the actual situation. Terms Apply*



First World Hotel Standard Room

Ideal For Two Adults Only



Features

- No frills, practical, compact room
- Ideal for two adults only
- WiFi coverage at lobby level only, upon purchase at Information Counter
- Located at Tower 1
- Average room size: 180 sq. ft.

Amenities

- In-room safe
- Telephone
- Standing shower
- Hair dryer
- Three-in-one shampoo
- Hot and cold water dispenser located along floor corridor
- Not provided in room - Toiletry set, mineral water, coffee and tea sachet can be purchased at the vending machine located at the lobby lift landing



Picture For Illustration Only 图片仅供参考 RWG Website

所提供的行程及价格仅供参考，最终行程可能根据实际情况进行调整。受条款及细则约束。*

The provided itinerary and price are for reference purposes only; the final itinerary may be adjusted based on the actual circumstances. Terms and conditions apply. *



First World Hotel Deluxe Room

With Mini Fridge Ideal For Two Adults Only



Features

- No frills, practical, compact room
- Ideal for two adults only
- WiFi coverage at lobby level only, upon purchase at Information Counter
- Located at Tower 2
- Average room size: 180 sq. ft.

Amenities

- In-room safe
- Flat screen TV
- Telephone
- Standing shower
- Hair dryer
- Tea and coffee-making facilities
- 3-in 1 Liquid Soap
- Kettle
- Mini fridge
- Not provided in room -Toiletry set, mineral water, coffee and tea sachet can be purchased at the vending machine located at the lobby lift landing



Picture For Illustration Only 图片仅供参考 RWG Website

所提供的行程及价格仅供参考，最终行程可能根据实际情况进行调整。受条款及细则约束。*

The provided itinerary and price are for reference purposes only; the final itinerary may be adjusted based on the actual circumstances. Terms and conditions apply. *



First World Hotel Y5 Deluxe Room With Mini Fridge Ideal For Two Adults Only



Features

- **No frills, practical, compact room**
- **Chic and trendy room design**
- **Ideal for two adults only**
- **Located at Tower 3**
- **Average room size: 180 sq. ft**

Amenities

- **In-room safe**
- **Flat screen TV**
- **Telephone**
- **Standing shower**
- **Hair dryer**
- **Tea and coffee-making facilities**
- **Kettle**
- **3-in 1 Liquid Soap and Bar Soap**
- **Mini fridge**
- **Free Wi-Fi**
- **Not provided in room -Toiletry set, mineral water, coffee and tea sachet can be purchased at the vending machine located at the lobby lift landing**

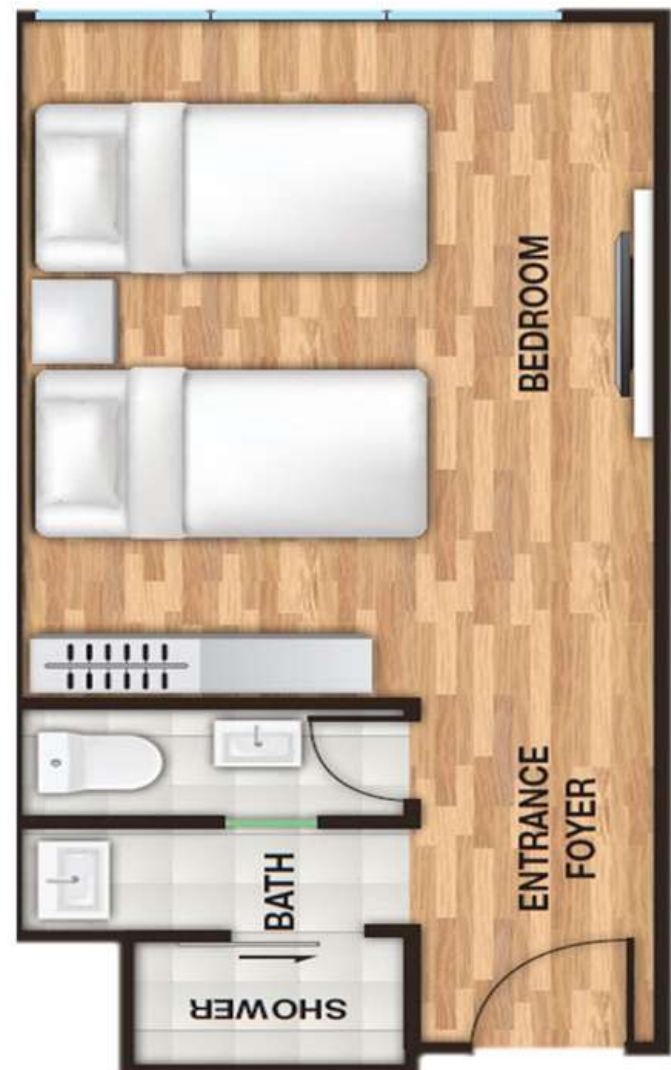

所提供的行程及价格仅供参考，最终行程可能根据实际情况进行调整。受条款及细则约束。*

The provided itinerary and price are for reference purposes only; the final itinerary may be adjusted based on the actual circumstances. Terms and conditions apply. *



First World Hotel Y5 Triple Room With Mini Fridge Ideal For Two Or Three Adults Only



Features

- No frills, practical, compact room
- Chic, trendy room design
- Ideal for two or three adults
- Located at Tower 3
- Average room size: 170 sq. ft

Amenities

- In-room safe
- Flat screen TV
- Telephone
- Standing shower
- Hair dryer
- Tea and coffee-making facilities
- Kettle
- 3-in 1 Liquid Soap and Bar Soap
- Mini fridge
- Free Wi-Fi
- Not provided in room -Toiletry set, mineral water, coffee and tea sachet can be purchased at the vending machine located at the lobby lift landing



所提供的行程及价格仅供参考，最终行程可能根据实际情况进行调整。受条款及细则约束。*

The provided itinerary and price are for reference purposes only; the final itinerary may be adjusted based on the actual circumstances. Terms and conditions apply. *



First World Hotel Superior Deluxe Room

With Mini Fridge Ideal For Two Adults Only



Features

- No frills, practical, compact room
- Ideal for two adults
- WiFi coverage at lobby level only, upon purchase at Information Counter
- Located at Tower 2
- Average room size: 320 sq. ft.

Amenities

- In-room safe
- Flat screen TV
- Telephone
- Bathtub or standing shower
- Hair dryer
- Tea and coffee-making facilities
- Kettle
- Mini fridge
- 3-in 1 Liquid Soap
- Complimentary mineral water
- Coffee table and sofa



Picture For Illustration Only 图片仅供参考 RWG Website

所提供的行程及价格仅供参考，最终行程可能根据实际情况进行调整。受条款及细则约束。*

The provided itinerary and price are for reference purposes only; the final itinerary may be adjusted based on the actual circumstances. Terms and conditions apply. *

First World Hotel

第一大酒店



World's largest hotel with the best value

The world's largest hotel offers an astronomical 7,351 rooms, a wide selection to spoil travellers of every budget.

First World Hotel is situated at the heart of Resorts World Genting, giving guests easy access to key locations such as the First World Plaza, SkyAvenue, Skytropolis Indoor Theme Park, and Genting International Convention Centre.

行程仅供参考, 最终行程可能会根据实际情况进行微调。须符合条规

The itinerary is for reference only, the final itinerary may be fine-tuned according to the actual situation. Terms Apply*



707-Inc Xpress



✓ Included

✓ **Coach Insurance**

✓ **Coach Transfer**

✓ **Hotel**

✗ Excluded

✗ **Travel Insurance**

✗ **Hotel Tax**

Coach Insurance 巴士上保險 Policy Schedule

For The Benefit Of: Coach Passengers Of The Policyholder Departure <u>Singapore</u> / Return <u>Singapore</u> ONLY 有效:新加坡出发 / 返回新加坡	Maximum Benefit Limit Payable Per Insured Person \$ SGD Singapore Dollars
1. Accidental Death & Permanent Disablement * 80 Years Old Above Coverage \$12,500	\$ 25,000
2. Accidental Medical Expenses	\$ 2,000
3. Emergency Medical Evacuation	\$ 1,000
4. Loss Of Baggage Due To Thief, Burglary Or Robbery (Police Report Required) 需要警方报告	\$ 200

Coverage: Underwritten By Chubb Insurance.

NOT Valid For Malaysia Interstate Travelers

One Way \$5.00

Two Way \$10.00

所提供的行程及价格仅供参考，最终行程可能根据实际情况进行调整。受条款及细则约束。*

The provided itinerary and price are for reference purposes only; the final itinerary may be adjusted based on the actual circumstances. Terms and conditions apply. *

Genting 云顶 707-Inc

Board And Alight Same Location.

Check In At Genting Main Terminal (Hilltop) 707-Inc Counter No. 1 (One) For Bus Number.
Present Your Voucher With Name, Date, Time, and Seat Number To Ground Crew Before Boarding.

在同一地点上车和下车。

请在云顶山顶巴士总站 707-Inc柜台一号报到及询问巴士号码。

在报到时, 请向707-Inc的工作人员出示您包含姓名、日期、时间和座位号的订单



www.707-inc.com

Check In

提早前往办理报到手续

30 Min



Genting Main Terminal (Hilltop)
Board and Alight Point
云顶山顶巴士总站BT3
上下车地点

LEGEND 图例



Parking 停车场



Hilltop Bus Terminal 山顶巴士总站

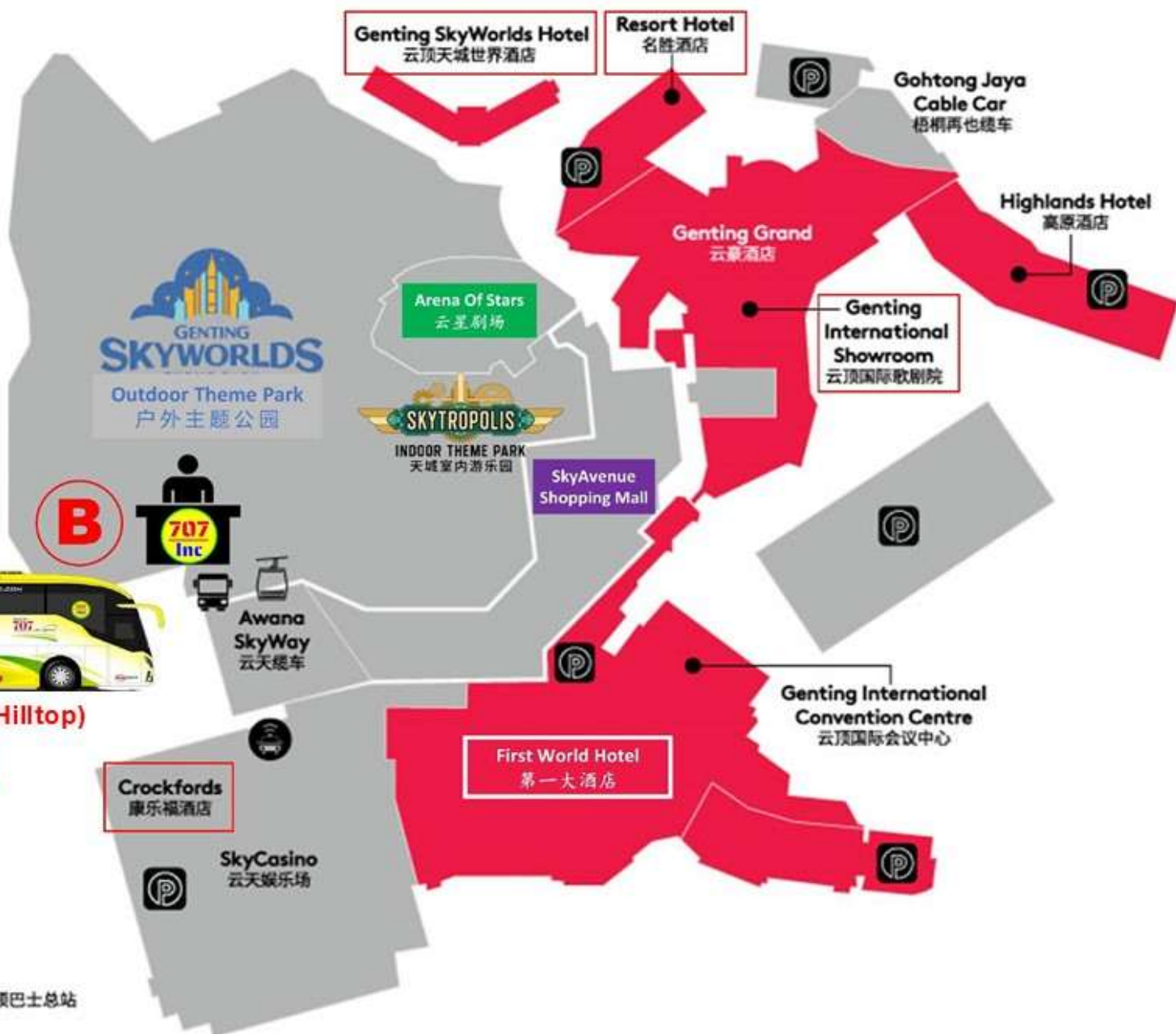

Genting Main Terminal (Hilltop) BT3 / Sky Avenue / Crockfords / First World
Are The Same Location 都在同一位置

Whatsapp Messages Only SG +65 8737 7707. Travel Info: www.707-inc.com/info



Daily 10:00 AM – 4:00 PM

Genting Main Terminal (Hilltop)
Bus Check In / Concert & Events
Redemption Counter

707-Inc No. 1 (One)

云顶山顶巴士总站
巴士车票 / 演唱会和特别活动
门票报到与兑换柜台
707-Inc 柜台一号



Check In Counter (1)
登记柜台(一号)

所提供的行程及价格仅供参考, 最终行程可能根据实际情况进行调整。受条款及细则约束。*

The provided itinerary and price are for reference purposes only; the final itinerary may be adjusted based on the actual circumstances. Terms and conditions apply. *



Genting 云顶

Place Of Interests

Skytropolis Indoor Theme Park
SkyWorlds outdoor Theme Park
Awana SkyWay
Genting Entertainment Facility
BigTop Video Games Park
Vision City Video Games Park
Sky VR
Genting Snow World
Ripley's Believe It Or Not
Genting Bowl

好玩景点

天城室内主题乐园
 天城世界主题乐园
 云天缆车
 云顶娱乐设施
 大本营电玩城
 梦幻电玩城
Sky VR
 云顶雪世界
 云顶信不信由你
 云顶保龄球场

Surrounding Explore

Chin Swee Caves Temple
Lim Goh Tong Memorial Hall
Genting Strawberry Leisure Farm
Gohtong Jaya
World of Phalaenopsis
Happy Bee Farm
Awana Horse Ranch

外围探索

清水岩庙
 林梧桐纪念馆
 云顶草莓园
 梧桐再也
 蝴蝶兰世界
 蜜蜂园
 牧马场

Food & Night Life Explore

Malaysian Food Street
Jom Makan Street Food
Genting Garden Hotpot
Starbucks Coffee
Han's Cha Chaan Teng
Burger & Lobster
Five Guys
Motorino Pizzeria
The Laughing Fish by Harry Ramsden
High Line
FUHU Restaurant
Zouk Genting
Cloud 9 Casual bar
Redtail Karaoke

美食与夜生活探索

马来西亚美食街
Jom Makan美食街
 云顶花园火锅
 星巴克咖啡
 汉记茶餐厅
 天台休闲美食街
 福虎餐厅
Zouk 夜店
Cloud 9 休闲酒吧
 卡拉ok

Shopping & Relax

SkyAvenue Complex
First World Complex
Genting Grand Complex
Genting Premium Outlets
Awana SkyCentral

购物与放松

云天综合大楼
 第一综合大楼
 云豪综合大楼
 云顶名牌折扣购物中心

所提供的行程及价格仅供参考，最终行程可能根据实际情况进行调整。受条款及细则约束。*

The provided itinerary and price are for reference purposes only; the final itinerary may be adjusted based on the actual circumstances. Terms and conditions apply. *



FLASH

SALE

Open Dated Theme Park Tickets

日期开放式
主题公园门票 **\$39**

SkyWorlds Theme Park: Theme Park Ride

www.gentingskyworlds.com/

- * SkyWorlds Outdoor Theme Park.
- * Redemption At 707- Inc Counter.
- * Closed Every Tuesday.
- * Except Malaysia Public Holidays.
- * No Amendment, Cancellation or Revalidate.
- * Ticket Sold NO REFUND. (Rain or Shine)



Auspicious Package

Dynamic Pricing Subject To Change, Limited Allotment

价格有变动的可能, 售完为止



Business Account

WhatsApp +65 8710 7707



www.707-inc.com

Favored ★★★★★ Sold 168 888

所提供的行程及价格仅供参考, 最终行程可能根据实际情况进行调整。受条款及细则约束。*

The provided itinerary and price are for reference purposes only; the final itinerary may be adjusted based on the actual circumstances. Terms and conditions apply. *